

Potton Town Council

www.freenetpages.co.uk/hp/pottontowncouncil

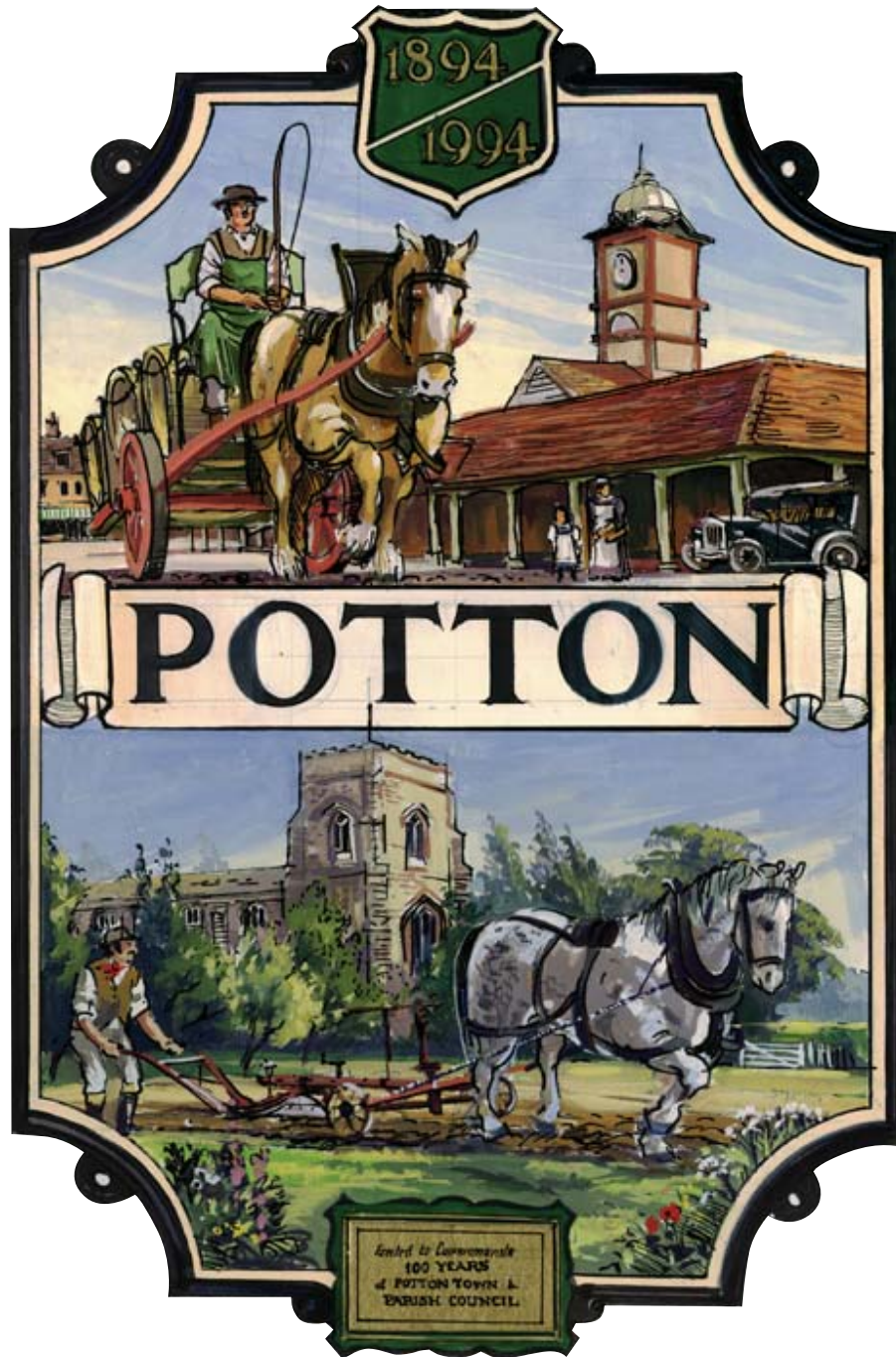

Newsletter
Summer 2007

SPECIAL EDITION...
INCLUDES PROPOSED PLANS FOR
POTTON MARKET SQUARE
ENHANCEMENT...

Chairman's Report

It is my pleasure to give my report for the year from the date of the last up to this Town Meeting. Whether this time next year I again do so or am even on the Town Council remains to be seen. My fate and that of eighteen others rests with you and all other registered electors of our Town. When I penned an item in our Spring Newsletter I was hopeful but not over optimistic that I would be able to trigger enough interest in the Town council activities to bring forward new faces prepared to influence decisions to benefit our residents. The result is a contest for the first time since the early 1980's and we are assured of at least three new councillors as that number are not seeking re-election on 3rd May.

The election to the Council is held every four years and normally would be concurrent with the District Council election which would lead to the cost borne by the Town being greatly reduced. While since the last contest the cost has not been incurred, this time by a paradox the full amount will be borne by us as there is no contest for the District. I do hope that there is a very large turnout at the poll.

On perusal of my report to you last year I note that much of it could be repeated tonight unaltered. The Council continues to provide facilities at Mill Lane Pavilion and at the Community Centre in Brook End plus the allotments in Everton Road for which there is a waiting list. Both halls are now used to a greater extent. A new storage area has been constructed at the Pavilion which houses the equipment of the pre school play group. This together with the CCTV has been funded by the generosity of Potton Consolidated Charities.

The football pitches are well used and are standing up to the constant use extremely well. The play areas both at Mill lane and at the Henry Smith Playing Field are a considerable asset well used by the young people of Potton.

Last year I referred to the pride we take in the well maintained cemetery in Sandy Road which compares favourably with all others in the District. I mentioned then how indebted we were to the cemetery caretaker Mick Whittle. He maintained the high standard to which we were accustomed until his retirement last month. His work was appreciated by the large number who attended the farewell party in the Community Centre when suitable gifts were presented and an appreciation given by the Chairman of the Cemetery Committee Eric Jakes.

Mick has been succeeded by Alan Litchfield who appears to be settling in to the role very well.

The caretakers of both Mill Lane and the Community Centre Ann Debenham and Sarah Williamson continue to maintain the premises to a high standard and Sarah has now taken on extra duties as assistant to our clerk Val Moles.

Since the office has been situate in the Community Centre our Clerk is visited by far more people than hitherto, and as her workload has increased (partly due to more services being delegated to Towns and Parishes) it has become necessary for Val to receive assistance. Sarah is now dealing, inter alia, with Hall Bookings.

Cont....

In the background a great deal of maintenance work is carried out by Peter Stonebridge our extremely handyman.

Last year I said that I was hopeful that by now the Town Centre Enhancement would have been completed. Delays have occurred due to the requirements of the District Council in relation to the management of funds for the work after that Council ceded management of the scheme to us. In addition County Council Highways Department and their contractors Amey had to determine where the work would fit into their schedule. I am pleased that our consultants having taken on board concerns arising from the earlier exhibition of the proposed alterations are now preparing revised drawings and a further display to be accompanied by an article in the Newsletter.

I have to pay tribute to the Party on Potton Committee who last summer put on several days activities and entertainment which attracted people from miles around.

Once again the Twinning Committee master minded the Christmas Lights which added a magical touch to our fine Georgian Square.

It certainly seems that the demands on the Council to provide for the Town become greater each year. Last year we had to take on the provision of Public Conveniences. This year we have incurred more expense in relation to the running costs of CCTV at Mill Lane and will very shortly meet the cost of the provision of a Police Community Support Officer. Ideally the police should provide for the Town's needs from their own resources. Due to the lack of funding from Central Government to ensure adequate policing your Council agreed it is necessary to meet the extra cost. Due to careful management it is noteworthy that the Town's precept for 2007/08 remains unchanged from the previous year at £105,000.

I am sorry that from this year's Council there will be three not seeking re-election. Jane Singleton resigned some three months ago, neither Tim Mason nor Simon Kimber are seeking re-election. I thank all three for their input to our deliberations and in particular to Simon who chaired Finance & General Purposes and Buildings & Facilities Committees.

I am appreciative of the support of all Council members, but in particular Jeremy Armond, Vice-Chairman and Chairman of the Planning Committee, Eric Jakes, Chairman of the Cemetery Committee and doyen of the council, whose experience is of inconsiderable benefit. I also appreciate the work of Mick Allen who has chaired the Playing Fields & Environment Committee since Tim Mason withdrew due to business pressures.

It would indeed be remiss of me if I did not publicly acknowledge the help and great support I have received from Anita both in Council and in relation to outside events I attended as the Town's Representative.

I allude earlier to Val's work load having increased in the last year so that she now has an assistant. She has served us efficiently, carrying out her duties with little fuss, whatever untoward events occurred. We are fortunate to benefit from her input that helps to ensure we deserve our status as a Quality Council.

John Lewis

What do I report to the Town Council ?

The Town Council is responsible for:

The Henry Smith Recreation Ground and play area

The Brook End car park

The Mill lane Recreation Ground and play area

The Community Centre in Brook End

The Pavilion at Mill Lane

The Council Chamber Meeting Room at the Clock House and the Town Clock

The Town Cemetery

The closed churchyard at St Mary's Church

Local grass cutting

Some of the street lights

Potton public conveniences

Any queries or bookings with regard to any of the above should be made to the Town Clerk.

Pottontowncouncil@freenet.co.uk or 01767 260086

or at the office during opening hours

What do I report to Mid Beds District Council?

The District Council is responsible for (amongst other things) waste collection, recycling, street cleaning and litter picking, the bottle banks, dog warden, pest control, street signs (road names)

All these items should be reported to

customer.services@midbeds.gov.uk or 08452 304040

or 01462 611 222

The Mid Beds District Council also deals with planning applications

What do I report to the County Council?

The County Council is responsible for (amongst other things) social services, education, the roads and highways safety signs, potholes, and drain gullies. All these items should be reported to

highways@bedscc.goc.uk

or Highways Helpline 01234 228661

The Clerk is always happy to advise or refer complaints to the correct authorities but a direct complaint will afford a faster response

Climate – it's the pace of change that should concern us

It is not unusual for the earth's average temperature to rise or fall over tens of thousands of years. However, climate scientists consider it 'very likely' that global warming is now being accelerated by the high volumes of man-made carbon dioxide (CO₂) in our atmosphere.

The ten warmest years on record have all occurred since 1995. Computer models explain this pace of warming only when man-made CO₂ is taken into account.

Whilst scientists predict that rapid climate changes will cause global difficulties in adapting, energy saving is something positive we can all do to prolong the availability of finite natural resources which will help us to adapt. Reducing CO₂ emissions is as straight-forward as insulating our homes, switching off lights and taking our foot off the accelerator.

For more energy saving information, contact the Energy Efficiency Advice Centre on 0800 512 012



Potton Town Centre

REVISED PROPOSALS FOR MARKET SQUARE

Introduction

You are invited to consider revised proposals for the enhancement of Potton Market Square. These proposals have been prepared with the support of the Potton Town Centre Partnership (TCP), which comprises councillors from Potton Town Council, Bedfordshire County Council, Mid Beds District Council and representatives of local traders.

What has happened in the past two years?

In the summer of 2005 proposals for the enhancement of the market square were subject to extensive public consultation but they were not supported, principally because of the loss of parking spaces.

Following a decision by Mid Beds District Council (MBDC) to withdraw from the direct management of the project it was necessary for the Town Council to prepare a 'business plan' to secure MBDC approval for the release the funds for the proposals.

As a result of these administrative changes there was an unavoidable delay in progress with the design and planning of the scheme. The design process was reactivated by the TCP and was focussed on the results of the consultation which took place in 2005.

Considerable efforts have been made to review the design from first principles and numerous ideas and options were considered and discussed by the TCP and with the County Council and their Safety Audit team. This took about a year and the design was reconsidered and agreed by the TCP in light of this comprehensive review.

The proposals now put forward are considered to be the best possible solution that maximises car parking whilst improving facilities for pedestrians and achieves a significant environmental enhancement within the budget available.

Essential requirements

The proposals must meet the requirements of the County Council in terms of highway safety and future maintenance. In practical terms this means:

- 'Head on' parking along the northern side of the square cannot be included;
- The bus stop must stay on the northern side of the square. This was confirmed following an on-site experiment in November 2006 and discussions with the Police;
- Crossing points must be provided to improve pedestrian safety whilst crossing to the central island and around the perimeter of the square. These must be designed so as to reduce the distance from kerb to kerb and include dropped kerbs and tactile paving;
- The size and shape of the central island needs to allow for manoeuvring by large vehicles
- The layout should discourage unauthorised parking where this would interfere with vehicle movements and safety.

In addition, as about half of the funding for this scheme has been secured from developers of other sites in Potton this money must be spent on enhancing the town centre or improving facilities for public transport and cycles.

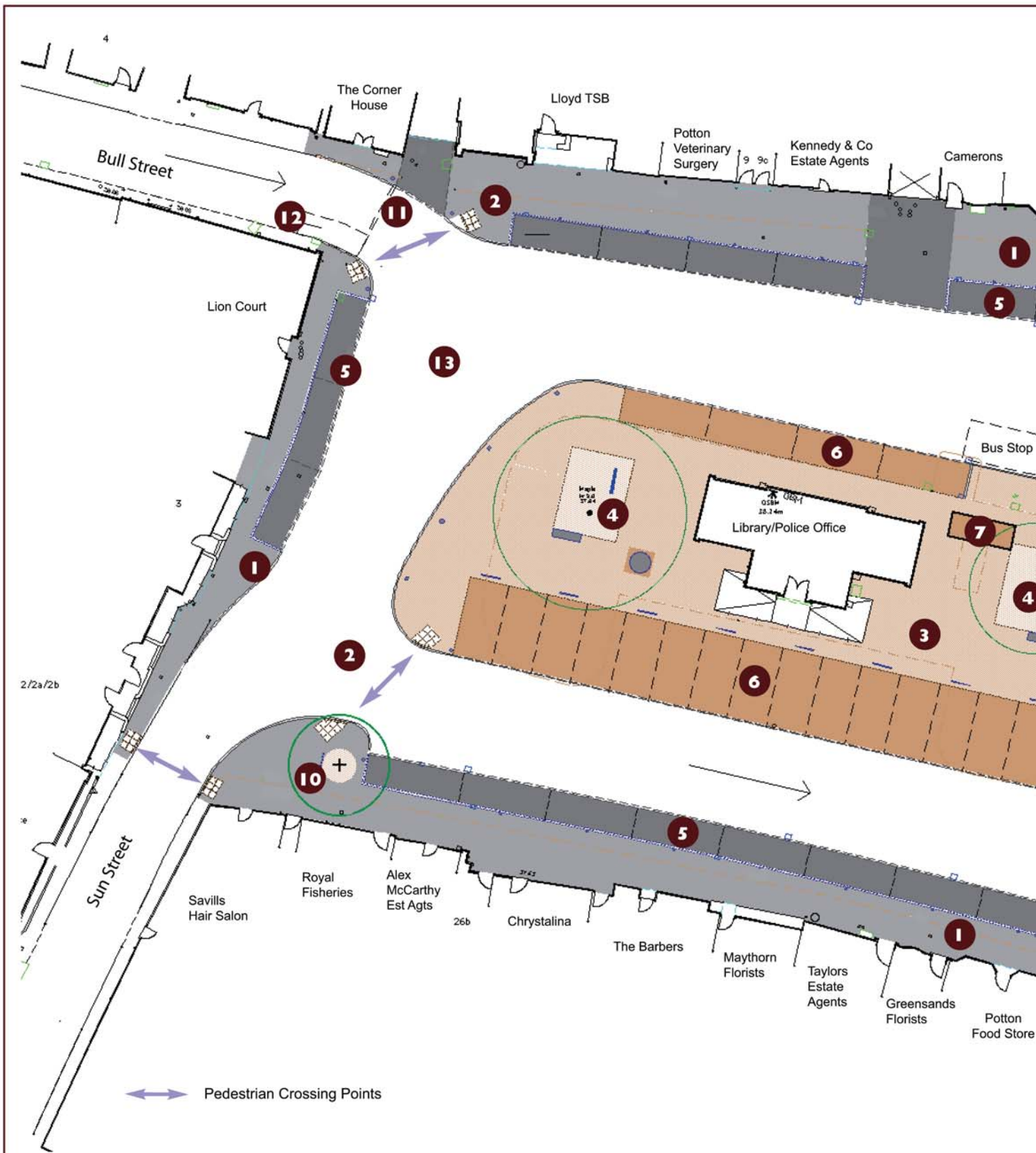

Main proposals

- 1** Footway widened in macadam construction and resurfaced in macadam to match widening

2 Pedestrian 'dropped crossing points' with tactile paving
- 3** Enlarged central area resurfaced in resin bound gravel aggregate

4 Porous resin bound gravel aggregate surfacing for existing tree surrounds
- 5** Parking bays repositioned and surfaced in asphalt

6 Parking bays raised to pavement level to allow occasional extension of pedestrian use and surfaced in buff coloured concrete setts

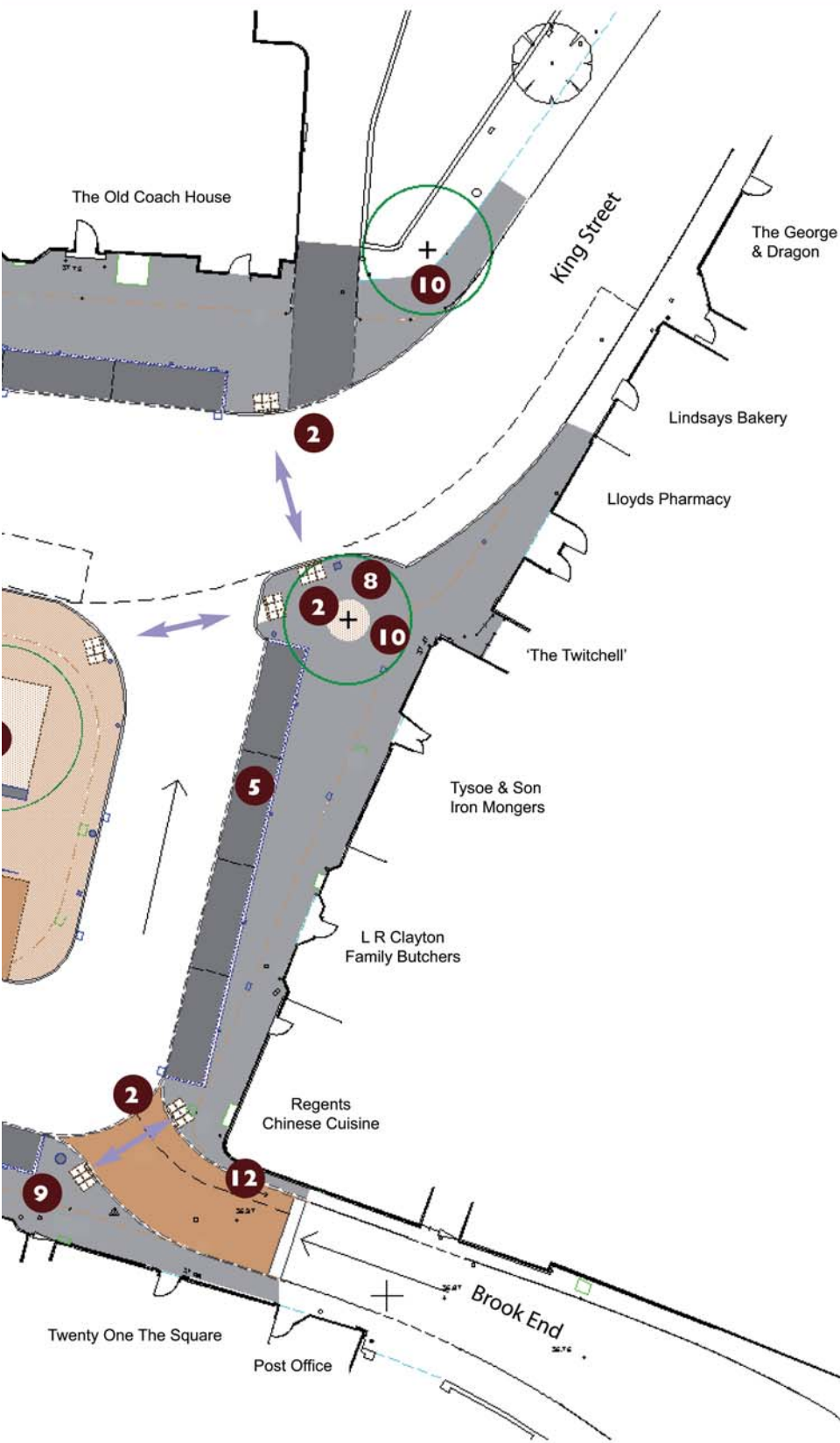

- 7 Bus shelter (design to be agreed)
- 8 Milepost refurbished and relocated close to original position
- 9 Post box relocated
- 10 Semi mature trees with porous tree surrounds

- 11 Bull Street made 'no-entry' from Market Square (except cycles)
- 12 'Contraflow' cycle lane
- 13 Carriageway resurfaced

DESIGN CONCEPTS

The design proposal for the market square:

- gives more space to pedestrians by widening the footways in front of the shops
- enlarges the central island to allow more room for occasional markets and events
- provides pedestrian crossing points away from parked cars
- retains car parking, but locates it to improve the views into and across the square
- re-positions wine press, provides new cycle parking and replaces litter bins and seats.

CAR PARKING

The amount of car parking spaces is sufficient for 44 cars. This is about 3 spaces less than at present. The reduction of numbers is necessary to allow better crossing places to be created for pedestrians. The widening of footways does not reduce car parking spaces.

If the improvements to crossing places were to be provided on their own there would still need to be a reduction of at least 3 parking spaces.

LOADING

One of the issues considered by the TCP is whether some parking bays should be made available for deliveries to shops for part of each day – possibly between 8.00 and 10.00. As part of this consultation we are seeking views about whether this would be supported and if so whether there is a preferred location.

HOW CAN YOU COMMENT ON THE CURRENT PROPOSALS?

Attend the exhibition

There will be a public exhibition of the proposals in the Community Centre on Brook End which can be viewed during normal opening hours (9.00 am to 1.00pm on Monday to Wednesday). In addition representatives of the design team and the Town Centre Partnership will be present in the Community Centre on the following dates to discuss the proposals and answer questions.

Wednesday 27 June – 3.00pm -7.00pm

Saturday 30 June - 10.00am – 1.00pm

You can also let us have your comments by:

- Completing and posting the attached form
- Sending an email to the Town Council on pottontowncouncil@freenet.co.uk
- Writing to the Town Council

The closing date for comments is Friday 20 July 2007

WHAT HAPPENS NEXT?

The comments made during this public consultation will be considered by the TCP and any changes will be agreed. If the scheme is approved by the Town Council there are a number of actions necessary before the works can begin:

- Detailed design and specification of the works will be completed;
- A Listed Building application will be made to Mid Beds District Council to relocate the milepost; and
- Bedfordshire County Council will advertise any necessary amendments to the parking and waiting restrictions.

Subject to all the necessary approvals being obtained it is anticipated that the works will begin on site in April 2008 and will be substantially completed by the end of June.

What happens if agreement cannot be reached?

If no agreement can be reached on the proposals it is anticipated that Mid Beds District Council will withdraw their funding for the scheme and the money raised from developers will be returned to them thereby leaving the Market Square in its current state. Any improvements, such as resurfacing pavements will need to await funding from the County Council.

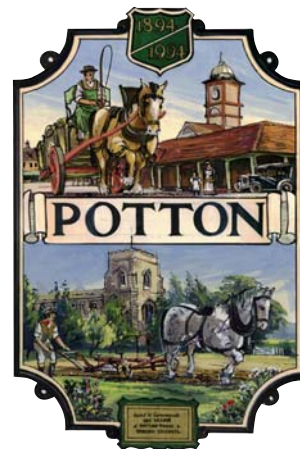

Bedfordshire
county council



Let us know what you think by completing this short questionnaire.
Please cut or tear off the form and fold it as described and then post it.
No stamp is required.

Q1 Taking the proposals as a whole do you think they are acceptable? Yes No

If 'no', are there any changes that could make them acceptable to you?
If so please describe briefly below

Q2 In principle would you support the introduction of a waiting restriction that would allow a small number of parking spaces (3 or 4) to be available between 8.00am and 10.00 am on Monday to Friday for vehicles delivering to shops and businesses? Yes No

If 'yes', so which of the following locations would you support.
Mark any that are acceptable.

- The 3 spaces outside Lloyds Pharmacy
- The 4 spaces outside Tysoe and Son to Regent Chinese Cuisine
- Other – please describe your preferred location

Q3 It would be helpful if you could also provide this information:

Are you (tick all that apply)

- A resident of Potton - if so which street do you live in?
- A resident of a nearby town / village. If so please give name
- A shop owner
- A manager of a business
- Other - please specify

Q4 If you are responding on behalf of a group, company or organisation please tell us the name and address.

Q5

Please use this space for any other comments you may have regarding the enhancement of Potton Town Centre

Thank you for helping us with the proposals for the town centre.

First fold

Third fold and tuck



Freeport RRRR-JAXZ-CAGT
Potton Town Council
The Community Centre
Brook End
Potton
SANDY
SG19 2QS

Second fold

Town Council Information

Town Council Office, The Community Centre, Brook End, Pottton SG19 2QS

Town Clerk Valerie Moles

Telephone/Fax 01767 260086

Email pottontowncouncil@freenet.co.uk

Office opening hours:

Monday 9am to 12.30am

Tuesday 9am to 12.30pm

Wednesday Closed

Thursday 9am to 12.30pm and 2pm to 4pm

Friday Closed

Town Councillors

Mick Allen	260227
Jeremy Armond	260521
Richard Baker BEM	260212
Jim Burke	261275
Ruth Burmo	260712
Nigel Butlin	260075
Geoff Emery	261710
Eric Jakes M.B.E.	260779
Sharom Kingham	261213
Peter Langridge	260362
Alan Leggatt	260001
Anita Lewis	260726
John Lewis	260726
Brain Lilley	261044
Jean Way	260456

Mr P. Langridge is Chairman of Town Council

Mr A. Leggatt is Vice Chairman of the Town Council

Mr Armond is Chairman of Planning Committee

Mr Leggatt is Chairman of Financial and General Purposes Committee

The Burials, Playing Fields, Buildings and Facilities and Transport Committees have yet to meet and elect a Chairman

The Town Council meets on the first Tuesday of every month except August. Meetings are usually held on the first floor of the Clock House in the Market Square and start at 7pm. Committee Meetings are held on the third Tuesday of each month at the same venue, starting at 7.00 p.m. If you wish to attend a meeting and would find access to the first floor Council Chamber difficult, please notify the Clerk as soon as possible prior to the meeting

Other Council Representatives for Pottton

County Councillor

Richard Baker B.E.M 260212 Richard.baker@bedscc.gov.uk

Mid.Beds.District Councillors

Doreen Gurney 680395 doreen.gurney@midbeds.gov.uk

Anita Lewis 260726 anita.lewis@midbeds.gov.uk

John Lewis 260726 john.lewis@midbeds.gov.uk

Summary of Town Council Accounts Financial year 2006-2007

Income	Total 2005/6	Total 06/07
Precept	£100,000	£105,000
Cemetery	£5,098	£3,843
Grants/Donations	£1,105	£15,967
Interest	£1,938	£3,015
Hire of Grounds	£1,577	£2,132
Grass cut for B C Council	£1,299	£1,406
Refund of VAT	£6,229	£4,209
Allotments	£530	£675
Hire C. Centre & Pavilion	£15,898	£20,263
Other Income	£1,720	£10,775
	£135,394	£167,300
Expenditure		
Community Centre	£11,492	£10,891
Mill Lane Pavilion	£12,022	**£21,704
Recreation Grounds	£11,162	£10,255
Admin/office	£37,990	£52,275
Clock House/Market Sq.	£1,599	*£5,522
Allotments	£379	£380
Cemetery	£19,036	£25,482
New Play Equipment	£0	£8,703
Other Expenditure	£0	£9,975
Street Lighting	£782	£450
Grass Cut Town Verges	£2,379	£2,052
VAT	£3,716	£9,644
Public Conveniences		£9,402
Car Park		£2,817
	£100,557	£169,552

Hourly Charges for Use of Town Council Facilities

Community Centre, Brook End, Potton as from 1st September

	Up to 5pm Weekdays	5pm to 10.30pm Weekdays	Weekends/Bank Holidays
Main Hall	£6.00	£7.00	£8.50
Upper Hall	£3.80	£4.50	£5.30
Both Rooms	£9.00	£10.50	£12.60

Mill Lane Pavilion, Mill Lane, Potton

	Up to 5pm Weekdays	5pm to 10.30pm Weekdays	Weekends/Bank Holidays
Pavilion	£6.80	£9.50	£13.00

There is a one and a half-hour minimum charge for the premises for non-commercial users and a two hour minimum charge for commercial users.

Football Pitches – price per game:

Local Colts	£12.00
Local Cubs	£6.00
Local Adults	£24.00
Casual Users – Local	£30.00
Casual Users – Other	£40.00

Hire of Pavilion by Local Sporting Groups:

Full Day (10-6pm)	£50.00
Afternoon	£25.00

Potton Library

Opening Hours		
Monday	2pm	to 6pm
Wednesday	2pm	to 6pm
Friday	10am	to 1pm
	2pm	to 6pm
Saturday	10am	to 1pm

- Free Wireless Internet transmitting 24-7
- Daily and weekly newspapers are available
- The librarians, Lesley and Gillian, will be happy to answer any queries on 01767 260740